

LOCATION PLAN OF G+III STORIED RESIDENTIAL BUILDING AT PREMISES NO. - **891, PURBACHAL ROAD**, WARD NO.- 106, BOROUGH NO.- XII, UNDER R.S. DAG NO. - 4183, R.S. KHATIAN NO.- 1613, MOUZA- KASBA, J.L. NO.- 13, P.S.- GARFA.

SITE CO-ORDINATES IN WGS 84 AND SITE ELEVATION (AMSL) -			
REFERENCE POINTS MARKED IN SITE PLAN OF THE PROPOSAL.	CO-ORDINATES IN WGS 84		SITE ELEVATION (AMSL)
	LATITUDE	LONGITUDE	
(A)	22°30'26"N	88°23'47"E	6.00 M.

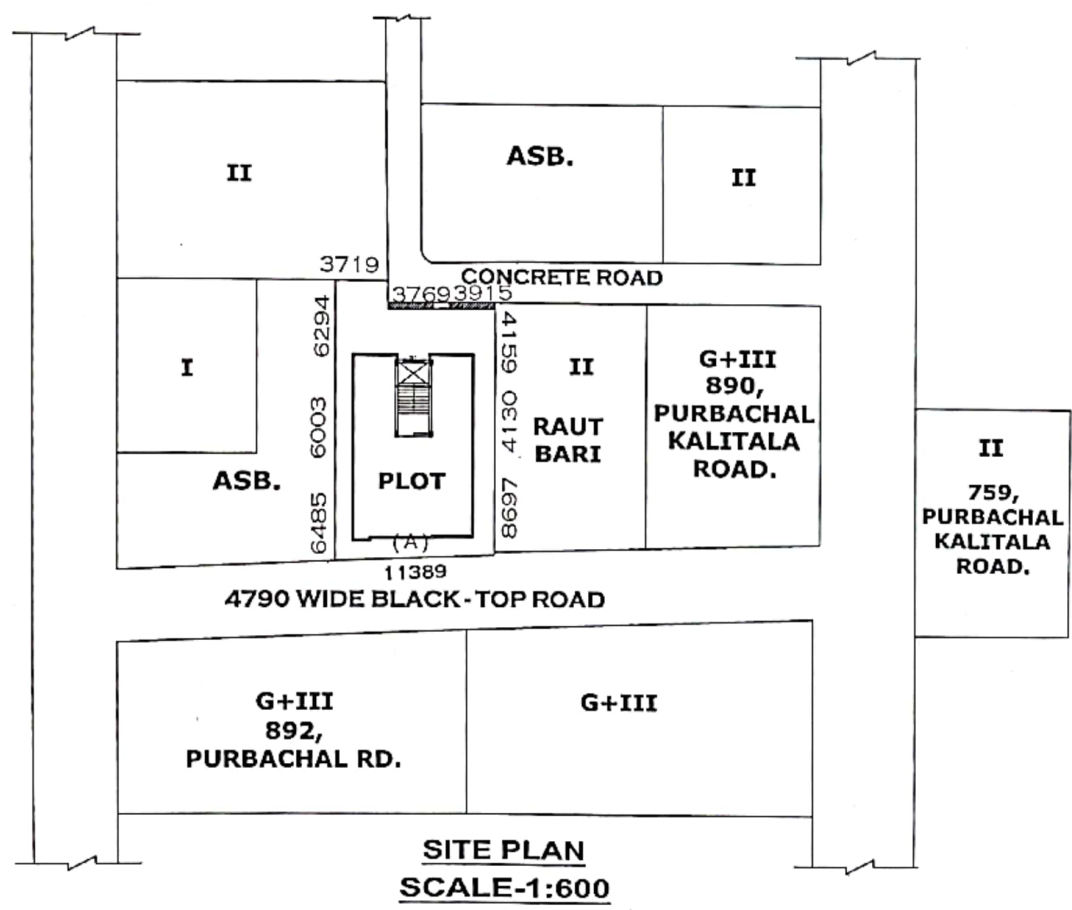
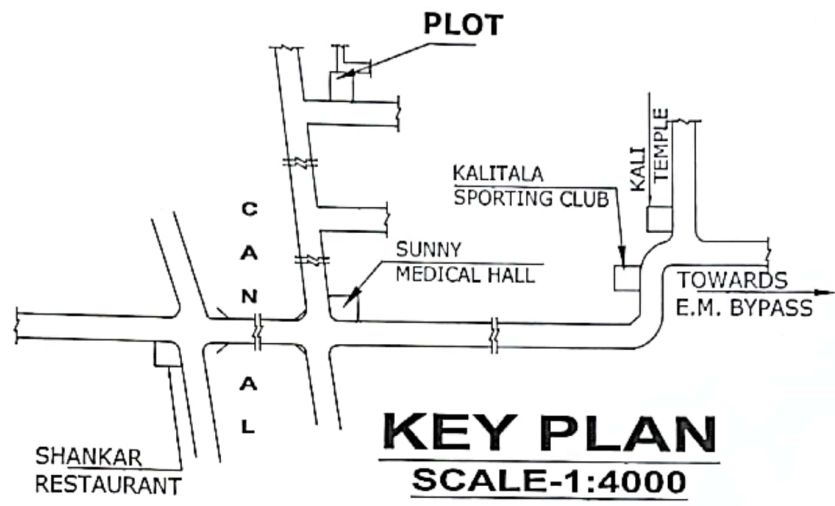

PARIJAT DEVELOPER
Gopal Prannanthy
Partner

SIGNATURE OF DEVELOPER

Hiranmoy Sarker
HIRANMOY SARKAR
L.B.S. (K.M.C.) CL-1 No.-1016

SIGNATURE OF L.B.S.